

CRUSE & ASSOCIATES

PROFESSIONAL LAND SURVEYORS

HANSON DESCRIPTIONS

12/9/10

East Parcel (No. 81 Rd) - 18.59 ac

The Southwest 1/4 of the Northwest 1/4 of Section 1, Township 17 North, Range 19 East, W.M., in the County of Kittitas, State of Washington:

EXCEPT That portion of said Southwest 1/4 of the Northwest 1/4 described as follows: Beginning 30 feet east of a point on the section line which is 491.0 feet north of the quarter section corner on the west line of said Section 1; thence running north along the east line of the county road to the north boundary of said Southwest 1/4 of the Northwest 1/4; thence east 1000.00 feet; thence south to a point that bears east of the point of beginning; thence west 1000.00 feet to the point of beginning and end of described parcel;

AND EXCEPT That portion of the Southwest 1/4 of the Northwest 1/4 of Section 1, Township 17 North, Range 19 East, W.M., in the County of Kittitas, State of Washington, which is described as follows:

Beginning at the northwest corner of Parcel 1 of that certain survey as recorded December 5, 2000, in Book 25 of Surveys at page 174, under Auditor's File No. 200012050014, records of said county; thence N 88°17'00" E, along the north boundary and north boundary extended of said Parcel 1, 346.64 feet to an existing north-south ditch; thence along said ditch the following three courses: S 00°07'45" E, 145.80 feet; S 44°08'41" W, 224.36 feet; and S 30°55'35" W, 202.36 feet to the south boundary of said Parcel 1; thence S 88°17'00" W, along said south boundary, 96.64 feet to the south west corner of said Parcel 1; thence N 01°13'00" E, along the west boundary of said Parcel 1, 473.00 feet to the true point of beginning and end of described parcel;

AND EXCEPT A tract of land within said Southwest 1/4 of the Northwest 1/4, 30 feet in width, conveyed to Kittitas Reclamation District by deed dated May 10, 1930, recorded in Book 48 of Deeds, page 562, records of Kittitas County, Washington;

AND EXCEPT right of way of No. 81 Road along the west boundary thereof.

All as per attached Exhibit.

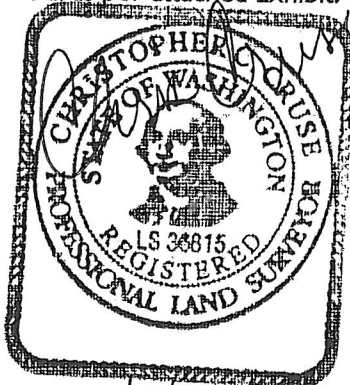

12/9/2010



CRUSE & ASSOCIATES

PROFESSIONAL LAND SURVEYORS

HANSON DESCRIPTIONS (cont.)

12/9/10

West Parcel (No. 81 Rd) - 2.72 ac

That portion of the Southwest 1/4 of the Northwest 1/4 of Section 1, Township 17 North, Range 19 East, W.M., in the County of Kittitas, State of Washington, which is described as follows:

Beginning at the northwest corner of Parcel 1 of that certain survey as recorded December 5, 2000, in Book 25 of Surveys at page 174, under Auditor's File No. 200012050014, records of said county; thence N 88°17'00" E, along the north boundary and north boundary extended of said Parcel 1, 346.64 feet to an existing north-south ditch; thence along said ditch the following three courses: S 00°07'45" E, 145.80 feet; S 44°08'41" W, 224.36 feet; and S 30°55'35" W, 202.36 feet to the south boundary of said Parcel 1; thence S 88°17'00" W, along said south boundary, 96.64 feet to the south west corner of said Parcel 1; thence N 01°13'00" E, along the west boundary of said Parcel 1, 473.00 feet to the true point of beginning and end of described parcel.

All as per attached Exhibit.

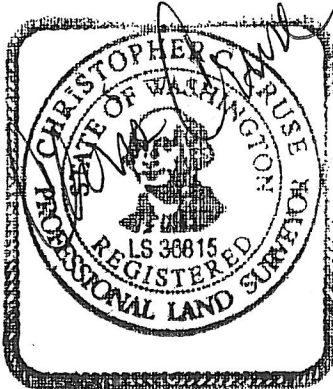

12/9/2010



EXHIBIT

NORTH BOUNDARY OF SW 1/4 OF NW 1/4
1000.00'

NO. 81 RD.

NORTHWEST CORNER PARCEL 1

1000.00'

346.64'

EXISTING
DITCH

S00°07'45"E
145.80'

PARCEL 1
BOOK 25 OF SURVEYS
PAGE 174

S44°08'41"W
224.36'

EAST PARCEL
18.59 acres

S30°55'35"W
202.36'

N01°13'00"E 473.00'

96.64'

S88°17'00"W

WEST PARCEL
2.72 acres

CRUSE & ASSOCIATES

PROFESSIONAL LAND SURVEYORS

HANSON DESCRIPTIONS (cont.)

12/9/10

Vantage Highway Parcel - 79.30 ac

Government Lots 1 and 2, and the Southwest 1/4 of the Northeast 1/4, all in Section 1, Township 17 North, Range 19 East, W.M., in the County of Kittitas, State of Washington; EXCEPT

1. Right of way of State Highway No. 7 along the North boundary line thereof;
2. Right of way of Caribou County Road along the Easterly boundary line thereof;
3. A tract of land within said Lot 2 and the Southwest 1/4 of the Northeast 1/4, 30 feet in width, heretofore conveyed to Kittitas Reclamation District by deed dated May 10, 1930, recorded in Book 48 of Deeds, page 562;
4. That part of Government Lot 1 of said Section 1, lying East of the County Road;
5. That portion of Government Lot 1, of said Section 1, which is bounded by a line described as follows:

Beginning at the Northeast corner of said Government Lot 1; thence South along the boundary of said Government Lot 1, 8.1 feet to the North right of way boundary of State Highway No. 7; thence South 89°41'48" West, along said North boundary, 379.80 feet; thence South 13°03'18" West, 102.78 feet to the true point of beginning; thence South 13°03'18" West, 446.47 feet; thence North 82°02'20" West, 384.32 feet; thence North 0°18'12" West, 379.15 feet; thence North 89°41'48" East, 483.48 feet to the true point of beginning.

6. That portion of Government Lot 2 of Section 1, Township 17 North, Range 19 East, W.M., in the County of Kittitas, State of Washington, which is bounded by a line described as follows:

Beginning at the Northwest corner of said Government Lot 2, thence South 0°56'55" West along the West boundary of said Government Lot 2, 51.07 feet to the true point of beginning; thence South 0°56'55" West, 90.28 feet; thence South 33°59'51" East, 19.12 feet; thence South 0°52'38" West, 296.50 feet; thence North 54°48'08" East, 191.10 feet; thence North 67°38'23" East, 249.64 feet; thence North 43°59'26" East, 175.01 feet; thence North 1°16'46" East, 86 feet; thence South 88°23'44" West, 515.35 feet to the true point of beginning.



CRUSE & ASSOCIATES

PROFESSIONAL LAND SURVEYORS

HANSON DESCRIPTIONS (cont.)

12/9/10

7. That portion of Government Lot 1 and Government Lot 2 of said Section 1, which is bounded by a line described as follows:

Beginning at a point on the South boundary of State Highway right of way, which is 50 feet South of a point 747 feet East of the Northwest corner of the Northwest 1/4 of the Northeast 1/4 of said Section, to the true point of beginning; and running thence South, parallel to the West boundary line of said quarter section, 357 feet; thence East 821 feet; thence Northerly 357 feet to a point on said South boundary of State Highway right of way which is 838 feet East of the true point of beginning; thence West along said boundary of State Highway 838 feet to the point of beginning.

8. Parcel 1 of that certain survey as recorded November 4, 2003, in Book 29 of Surveys at pages 116-117, under Auditor's File No. 200311040015, records of said county;

9. That portion of Government Lot 1, Section 1, Township 17 North, Range 19 East, W.M., in the County of Kittitas, State of Washington, which is described as follows:

Beginning at the northeast corner of said Government Lot 1, thence South along the boundary of said Government Lot 1, 8.1 feet to the north right of way boundary of State Highway No. 7; thence S 89°41'48" W, along said north boundary, 379.80 feet; thence S 13°03'18" W, 549.25 feet; thence N 82°02'20" W, 384.32 feet to the true point of beginning for said described parcel; thence S 00°18'12" E, 518.98 feet to the center of an existing ditch or extension of existing ditch that bears easterly; thence along said ditch and ditch extended the following three courses: S 66°29'28" E, 162.33 feet; N 42°59'53" E, 117.16 feet; and S 82°13'50" E, 134.50 feet to the westerly right of way of the county road; thence northerly along said westerly right of way, 484.82 feet to a point that bears S 82°02'20" E from the true point of beginning; thence N 82°02'20" W, 384.32 feet to the true point of beginning and end of described parcel.

All as per attached Exhibit.

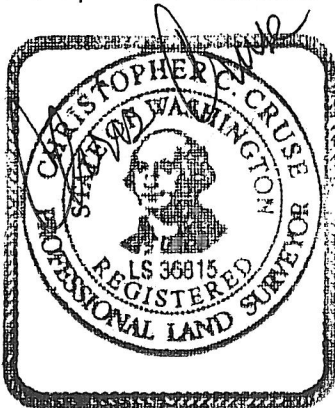

12/9/2010



CRUSE & ASSOCIATES

PROFESSIONAL LAND SURVEYORS

HANSON DESCRIPTIONS (cont.)

12/9/10

Caribou Road Parcel - 4.59 ac

That portion of Government Lot 1, Section 1, Township 17 North, Range 19 East, W.M., in the County of Kittitas, State of Washington, which is described as follows:

Beginning at the northeast corner of said Government Lot 1, thence South along the boundary of said Government Lot 1, 8.1 feet to the north right of way boundary of State Highway No. 7; thence S 89°41'48" W, along said north boundary, 379.80 feet; thence S 13°03'18" W, 549.25 feet; thence N 82°02'20" W, 384.32 feet to the true point of beginning for said described parcel; thence S 00°18'12" E, 518.98 feet to the center of an existing ditch or extension of existing ditch that bears easterly; thence along said ditch and ditch extended the following three courses: S 66°29'28" E, 162.33 feet; N 42°59'53" E, 117.16 feet; and S 82°13'50" E, 134.50 feet to the westerly right of way of the county road; thence northerly along said westerly right of way, 484.82 feet to a point that bears S 82°02'20" E from the true point of beginning; thence N 82°02'20" W, 384.32 feet to the true point of beginning and end of described parcel.

All as per attached Exhibit.

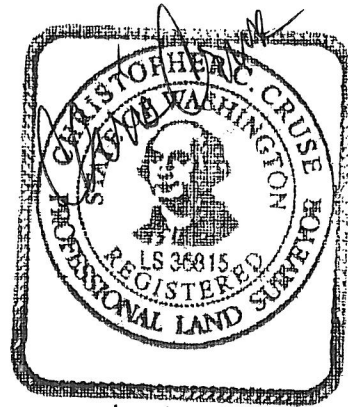

These descriptions are based on information of record.
No field work was done by Cruse & Associates.

12/9/2010



EXHIBIT

